

# BEYOND METROPOLIZATION

*Exploring new hybrids*

# PROGRAM

## DAY 1 Wednesday June 28th 2023

---

**13.30** Registration and coffee

**14.00-18.00** Parallel Sessions

#1a. Inhabiting urban rural hybrids

*room: B4 (spiral stairs, 1st floor)*

#1b. Cross-borders territories: mobility, migrations

*room: B6 (spiral stairs, 1st floor)*

#1c. Productive territories: circularity and conflicts

*room: B7 (spiral stairs, 1st floor)*

**18.00-18.15** Introduction (C. Cavalieri, B. Grosjean)

**18.30-19.30** Key-note speech conference

(Re)connection: which metabolism for which city?

Sabine Barles (Université Paris 1er, F)

*Room: Grand Amphitheatre Bossard (Entrance atrium, floor -1)*

**19.30-21.00** Cocktail

*Room: salle Mallet-Stevens (spiral stairs, floor -1)*

## DAY 2 Thursday June 29th 2023

---

**8.00-13.30** Site visit and lunch

Eurometropolis Lille Kortrijk Tournai – “Le parc Bleu”

**8.00** MEETING POINT: Av. Le Corbusier, in front of the hotel Lille Europe

**08.15-09.00** Road trip to Tournai

**09.15-11.00** Visit : Les Fours à chaux

**11.00-11.30** Road trip to Kortrijk

**11.30-12.30** Visit : riverbanks and city renewal

**12.30-13.00** Picnic Begijnhofpark

**13.00-13.45** Transport to ENSAP (Villeneuve d'Ascq)

## 14.00-18.00 Parallel Sessions

#2a. New insights into History: building and planning

room: B4 (spiral stairs, 1st floor)

#2b. Foodscapes : from farmlands to agro-parks

room: B6 (spiral stairs, 1st floor)

#2c. Water urbanisms

room: B7 (spiral stairs, 1st floor)

#2d. Social actions : from sharing to appropriations

room: B9 (spiral stairs, 1st floor)

## 18.30-19.30 Key-note speech conference

Qu'est-ce qu'un développement vraiment durable ?

What's a truly sustainable development ?

Pierre Caye (CNRS, FR), conférence en français, with simultaneous translation in English.

Room: Grand Amphitheatre Bossard (Entrance atrium, floor -1)

## 20.30 Social dinner (on reservation)

*Le Barbue d'Anvers*

1, rue St Etienne, Lille (Grand Place, Métro Rihour, ligne 1)

## DAY 3 Friday June 30th 2023

---

### 8.30-9.00 Welcoming

### 9.00-12.30 Parallel Sessions

#3a. Between soils and sub-soils : Mining landscapes

room: B6 (spiral stairs, 1st floor)

#3b. Commons and nature

room: B7 (spiral stairs, 1st floor)

#3c. Socio-ecological movements and configurations

room: B9 (spiral stairs, 1st floor)

### 12.30-13.30 Lunch

### 13.30-15.00 Roundtable Exploring hybrids

Moderators: Benedicte Grosjean, ENSAP / Ulille (FR) ; Chiara Cavalieri, UCLouvain (BE).

with: Sebastien Marot ENSA Paris-Est (FR); Paola Viganò, EPFLausanne (CH);

Kelly Shannon, KULeuven (BE); Maria Chiara Tosi, IUAV Venice (IT) ; Michiel Dehaene, Ugent (BE). Brian McGrath, Parsons School for Design (US)

Room: Amphitheatre Dubuisson (red stairs, level +1)

## DETAILS

### Session # 1a\_inhabiting urban rural hybrids

---

Chair: *Adolf Sotoca, UPCatalunya (ES)*

Discussants: *Anne Kockelkorn, Ughent (BE), Elena Cogato Lanza, EPFLausanne (CH), Gery Leloutre, ULBruxelles (BE), Guillaume Vanneste, UCLouvain (BE), Michiel Dehaene, Ughent (BE), Nikos Katsikis, TU Delft (NL)*

14.00 Towards a framework for village urbanism: the village imaginary as a guiding image for the praxis and discourse on the transformation of peri-urban villages in Flanders. *Verbakel Ward, KULeuven (BE)*

14.45 Manufactured Altered Alps

*Tettoni Mattia, IUAVenice (IT)*

#### 15.30 Break

15.45 The monetisation of exchanges between city and countryside as an indicator of the urbanisation of Congolese territory. How is the urban phenomenon reflected in the case of Mbanza-Ngungu? *Kapasi Lutete Joel, ULBruxelles, (BE)*

16.30 Ruralization in urbanization in the Peasant Territories of Southern Mali: everyday life in Ségoukoura, Ségou

*Pietrobon Elvira, IUAVenice, (IT)*

17.15 Critically Mapping the Micropolitics of Varying Notions to Land in Alshigelab (Janoob Al Hizam)

*El Jack, Khalda Imad Mubarak, KULeuven (BE)*

### Session # 1b\_Cross-borders territories : mobility, migrations

---

Chair: *Els Verbakel, Bezalel Academy of Arts and Design, Jerusalem (IL)*

Discussants: *Bénédicte Grosjean, ENSAP / U Lille (FR), Carola Hein, TU Delft (NL), Chiara Cavalieri, UCLouvain (BE), Kelly Shannon, KULeuven (BE), Maarten Gheysen, KULeuven (BE)*

14.00 The Borderlands in the test of representation : life paths of Roms families in Lille's metropolisation

*Lassalle Roman, UCL/Lille (BE/FR)*

14.45 TOD against the context in cross-border metropolis? Visions and paradoxes in the case of the Great Geneva Agglomeration

*Guichot Flore, EPFLausanne (CH)*

#### 15.30 Break

15.45 From lines and nodes to edges and dialogues in the dispersed territory. The case of former railway line 87 in the Eurometropolis Lille-Kortrijk-Tournai

*Leemans Sophie, KULeuven (BE)*

16.30 Rethinking extractive landscapes in cross-border areas

*Caravello Chiara, Uliège (BE)*

## Session # 1c\_Productive territories: circularity and conflicts

---

Chair: *Maria Chiara Tosi, IUAVenezia (IT)*

Discussants: *Brian McGrath, Parsons School for Design (US), Bruno de Meulder, KULeuven(BE), Bruno Notteboom, KULeuven (BE), Geoffrey Grulois, ULBruxelles (BE), Sabine Barles, Univ.Paris1 (FR)*

14.00 Manufacturing spaces in the Marais (Lille) and Heyvaert (Brussels) districts: hybridization and conflicts

*Scutari Ana, Ulille (FR)*

14.45 The Walloon industrial sillon: a figure of 21thcentury

*Calò Alessia, UCLouvain (BE)*

### 15.30 Break

15.45 Designing (with) soil in circular built environment transformations

*Timmers Charlotte, KULeuven (BE)*

16.30 Dalmine: From Company Town to Hybridized Productive Habitat

*Almeida Santos Anna Karla, EPFLausanne (CH)*

## Session # 2a\_New insights into History: building and planning

---

Chair: *Carola Hein (TU Delft, NL)*

Discussants: *Adolf Sotoca, UPCatalunya (ES), Bruno de Meulder, KULeuven (BE), Hessam Khoarasani, IUAV EHESS (FR), Tom Avermaete, ETH Zurich (CH), Tom Broes, Ugent (BE), Tommaso Pietropolli, EPFLausanne (CH)*

14.00 Construction History meets Planning History

*Verstraete Robrecht, ULBruxelles (BE)*

14.45 The anarchist thread of urban planning history: Reconstructing the continuous influence of anarchist ideas on the history and present of urbanism

*Kuzmanic Jere, UPCatalunya (ES)*

### 15.30 Break

15.45 Immanent Monuments or transcendent instruments? Four Roles for Post-war Churches in Sustainable Neighbourhood Transition.

*Ardui Charlotte, KULeuven (BE)*

16.30 Qualitative datascaping for historic cities in conflict: A grounded theory analysis for spatial sustainability. Case of Jaffa, Israel.

*Potdar Komal, TUDelft (NL)*

17.15 Urbanisation as land consumption, commodification and parceling out: Hybridities in spatial occupation in Bukavu

*Gulain Amani Mushizi, ULBruxelles (BE)*

## Session # 2b\_Foodscapes : from farmlands to agro-parks

---

Chair: *Michiel Dehaene, Ugent (BE)*

Discussants: *Elena Cogato Lanza, EPFLausanne (CH), Ivonne Weichold, LISER (LU), Nikos Katsikis, TU Delft (NL), Sébastien Marot, ENSA Paris-Est (FR)*

14.00 Agricultural islands in Paris metropolis. An investigation into possible interactions and complementarities between urban and food landscapes

*Thierry Axelle, ENSP Versailles (FR)*

14.45 Agro-social parks: an analysis of planning and design projects for Italian periurban areas

*Salvador Antonio Jose, Politecnico di Milano (IT)*

### 15.30 Break

15.45 Reintegrating Urban Agroecology in the Cape – An Urban Design. Investigation of Inclusive Landscape Strategies for Urban Food System Transformation in the Western Cape. *Truter Georgina, KULeuven (BE)*

16.30 Plots on hold: hybrid landscapes in rural Tamil Nadu through ordinary farmland conversions

*Frantz Marine, Univ. Paris1 (FR)*

17.15 Foodscapes: from soil to policies. Food as a design tool for landscape and territory.

*Ambrosi Amerigo Alberto, IUAVenezia (IT)*

## Session # 2c\_Water urbanisms

---

Chair: *Kelly Shannon, KULeuven (BE)*

Discussants: *Bénédictte Grosjean, ENSAP / U Lille (FR), Bruno Notteboom, KULeuven (BE), Chiara Cavalieri, UCLouvain (BE), Maarten Gheysen, KULeuven (B), Maria Chiara Tosi, IUAVenezia (IT), Paola Viganò, EPFL, IUAV (CH/IT)*

14.00 Imagining Public Space beyond metropolization

*Begum, Salma, KULeuven (BE)*

14.45 Gradients of wetness: a wet experiment towards wet transition

*Aragone Andrea, IUAVenezia (IT)*

### 15.30 Break

15.45 Water & sand: chronicles of collective trajectories from the valley of Bumbu river, Kinshasa (DRC).

*Manaresi Pietro, UCLouvain (BE)*

16.30 Developing Spatio-Temporal Mappings of the Polder Landscape in the Yangtze River Delta based on Educative Speculations

*Lei, Wei, KULeuven (BE)*

## 17.15 Water as ecosystems driver for the Ecological Transition in the Vietnamese Mekong Delta

*Nguyen Sylvie, EPFLausanne (CH)*

### Session # 2d\_Social actions : from sharing to appropriations

---

Chair: *Gery Leloutre, ULBruxelles (BE)*

Discussants: *Anne Kockelkorn, Ugent (EB), Brian McGrath, Parsons School for Design (US), Isabelle Doucet, Chalmers UT (SE), Tommaso Pietropolli, EPFL Lausanne (CH)*

## 14.00 Generative analogy for a collective action in urban design

*Jung Hee-Won, ENSA Paris la Villette (FR)*

## 14.45 Rich, poor and mechanism of sharing's in Hyderabad city, India.

*Sirimalla, Shyam, EPFLausanne (CH)*

### 15.30 Break

## 15.45 Social Relations and Landscape Transformations: Settling practices of Garhwali community

*Zeba, Amir, KULeuven (BE)*

## 16.30 Countering the Ongoing Metropolization Process and Neoliberal Logics. Experiences of Dwelling and Cohabitation in the New Neighborhoods of Ain El Aouda, Morocco

*Belkebir, Salma, ULBruxelles (BE)*

### Session # 3.a\_Between soils and sub-soils : Mining landscapes

---

Chair: *Bruno De Meulder, KULeuven (BE)*

Discussants: *B nedicte Grosjean, ENSAP / Ulille (FR), Brian McGrath, Parsons School for Design (US), Kristel Mazy, Umons (BE), Maria Chiara Tosi, IUAVenezia (IT), Viviana d'Auria, KULeuven (BE)*

## 9.00 Towards desealing as a widespread situated practice

*Broggini Federico, Roma3 (IT)*

## 9.45 Urban soil assessment: exploring constraints and environmental benefits of soil transformation.

*Bossard, Alexandre, UCLouvain (BE)*

### 10.30 Break

## 10.45 Formation, evolution and future of an architectural type – the mining habitat in northern France

*Niemann Sebastian, UCLouvain (BE)*

## 11.30 Landscapes of Migration. Displacement and the ecologies of urban ruins in mining settlements. The case of Limburg, Belgium.

*Zani, Jacopo, ETH Zurich (CH)*

## Session # 3b\_Commons and nature

---

Chair: *Geoffrey Grulois, ULBruxelles (BE)*

Discussants: *Denis Delbaere, ENSAP / Ulille (FR), Maarten Gheysen, KULeuven (BE), Paola Viganò, EPFL, IUAV (CH/IT), Sébastien Marot, ENSAParis-Est (FR)*

9.00 Rewriting the urban commons. A sustainable approach to urban logistics

*Fattorelli Samuel, IUAVenezia (IT)*

9.45 Visualising fluid territories: settling in and within shifts in the chars of Assam, India

*Swagata Das, KULeuven (BE)*

### 10.30 Break

10.45 Dakar is leaking. Mapping changes on the territory of urban drainage services through time

*Van den Bruel Evelien, UCLouvain (BE)*

11.15 Hopeful environmental stories. Limits and contradictions of ecological restoration pilot-projects in the Venice Lagoon

*Chouairi Amina, IUAVenezia (IT)*

## Session # 3c\_Socio-ecological movements and configurations

---

Chair: *Jeroen Stevens (KULeuven, BE)*

Discussants : *Elena Cogato Lanza, EPFLausanne (CH), Kelly Shannon, KULeuven (BE), Mathieu Berger, UCLouvain (BE), Tom Avermaete, ETH Zurich (CH)*

9.00 Liquid Narratives: Exploring Socio-ecological Practices in Southern São Paulo.

*Lerchs Lucas, UCLouvain (BE)*

9.45 The open spaces of housing estates, as laboratories of the living.

*Baës-Cantillon Nathanaëlle, UCLouvain (BE)*

### 10.30 Break

10.45 Co-creation of natural third-places in European cities: Community gardens in Krakow and Brussels.

*Téoule, Fanny, Jagiellonian University, Umons (BE)*

11.15 Contesting urban space: socio-ecological questions and the revisiting of the Brussels' counterproject.

*Inghelbrecht Eline & Pattyn Dries, KULeuven (BE)*



## CONFERENCES

Sabine Barles

### (Re)connection. Which metabolism for which city?

Wednesday 28.06.23, 18h30 grand amphithéâtre Bossard, ENSAP de Lille.

Sabine Barles is a professor of urban planning at Université Paris 1 Panthéon-Sorbonne and a researcher at UMR Géographie-Cités, where she heads the CRIA team. Her research interests range from the history of urban techniques and the urban environment (eighteenth to twenty-first centuries), to urban metabolism, territorial ecology and socio-ecological foresight.

Her recent publications include : *Pour la recherche urbaine*, Paris: CNRS Éditions, 2020 (co-dir. Félix Adisson, Nathalie Blanc, Olivier Coutard, Leïla frouillou, Fanny Rassat) ; *Métabolisme et métropole. La métropole lilloise, entre mondialisation et interterritorialité*, Paris: Autrement, 2021 (co-dir. Marc Dumont) ; *Le métabolisme de l'agglomération parisienne*, fascicule #20 du PIREN-Seine, Paris: éd. ARCEAU-IdF, 2021 (dir).

Pierre Caye

### Qu'est-ce qu'un développement vraiment durable ? What's a truly sustainable development ?

Thursday 29.06.23, 18h30 grand amphithéâtre Bossard, ENSAP de Lille.

(conférence en français, with simultaneous translation in English)

Pierre Caye, philosopher, is director of research at the CNRS. He founded the international research group «Savoirs artistiques et traités d'art de la Renaissance aux Lumières».

Former student of the École Normale Supérieure (Ulm), he has been developing for over 30 years research on the knowledge of architecture, urbanism and regional planning, and through these, on the question of technique, renewing thoroughly the genealogy of it, notably in: *Durer. Elements pour la transformation du système productif* (Belles Lettres, 2020). Other key publications include: *Critique de la destruction créatrice. Humanisme et production*, Paris, Les Belles Lettres, 2015; and *Morale et chaos. Principes d'un agir sans fondement*, Paris, Le Cerf, 2008.

**Abstract :** *For 50 years, ecology has been on the public policy agenda. Yet with what results? Everyone, right and left, now wants to «change the model». But are the best intentions enough? It's certainly important that our development is sustainable, and respects future generations. But we still have to be able to build sustainability into our very modes of production! Under the cover of time, the main factors would be transformed: capital becomes heritage, labor is devoted to maintenance, and technology serves as a protective envelope. Taking up the main themes of his latest book, Durer, Pierre Caye describes the tools for a global transformation of the production system.*

## **Scientific committee**

Adolf Sotoca, UPCatalunya  
Anne Kockelkorn, UGhent  
Bénédicte Grosjean, ENSAP / ULille (co-chair)  
Brian McGrath, Parsons The New School for Design (NY)  
Bruno de Meulder, KULeuven  
Bruno Notteboom, KULeuven  
Carola Hein, TU Delft  
Chiara Cavalieri, UCLouvain (co-chair)  
Denis Delbaere, ENSAP / ULille  
Elena Cogato Lanza, EPFLausanne  
Els Verbakel, Bezalel Acad. Arts&Design (Israel)  
Geoffrey Grulois, ULBruxelles  
Gery Leloutre, ULBruxelles  
Isabelle Doucet, Chalmers University of Technology  
Kelly Shannon, KULeuven  
Maria Chiara Tosi, IUAVenezia  
Mathieu Berger, UCLouvain  
Michiel Dehaene, Ugent  
Nikos Katsikis, TU Delft  
Paola Viganò, EPFL, IUAV  
Sabine Barles, Université Paris 1er  
Sébastien Marot, ENSA Paris-Est  
Tom Avermaete, ETH Zurich

## **Organising committee**

Bénédicte Grosjean, ENSAP / ULille  
Chiara Cavalieri, UCLouvain  
Maarten Gheysen, KULeuven  
Gery Leloutre, ULBruxelles  
Roman Lassalle, UCLouvain/ENSAP Lille  
Lucas Lerchs, UCLouvain  
Thaïs Delefortrie, UCLouvain

Lorraine Feugère (coord.), LACTH, ENSAP Lille  
Adrien Branswyck, LACTH, ENSAP Lille  
Hafid Ait Hifrane, ENSAP Lille  
Stéphane Beaudonnet, ENSAP Lille  
Anthony Galerneau, ENSAP Lille  
Charlotte Siekaniec, ENSAP Lille

## **Location**

ENSAP de Lille  
2, rue Verte  
59650 Villeneuve d'Ascq

**Métro** : hôtel de Ville, Ligne 1

## **Contacts**

mail: [UU2023@lille.archi.fr](mailto:UU2023@lille.archi.fr)  
web: <https://www.lille.archi.fr/uu2023/>

## LEVEL -1



## LEVEL +1

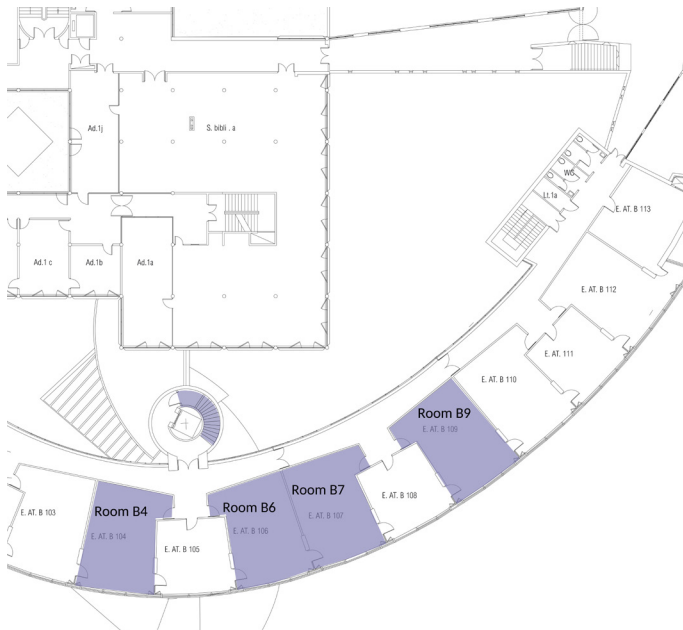



Soutenu  
par



**EUROMÉTROPOLE  
EUROMETROPOOL**  
LILLE ◦ KORTRIJK ◦ TOURNAI



**LACTH**  
CONCEPTION / TERRITOIRE / HISTOIRE / MATÉRIALITÉ